

PLAN VIEW

SEE NOTE #6

FULL BED OF
LEVEL GROUT
(1/2" MAX)

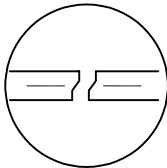

JOINT DETAIL
(WHEN NEEDED)

- NOTES**
1. CONCRETE - 4000psi, AIR ENTRAINED
 2. REINFORCING STEEL - GRADE 60, ASTM A-615 WWF 4X4 W4&W4 - ASTM A-185
 3. LADDER RUNGS - COPOLYMER POLYPROPYLENE PLASTIC w/1/2" REBAR, GRADE 60
 4. H-20 LOADING
 5. LOCATIONS OF PIPE OPENINGS AS REQUIRED
 6. FRAME AND GRATE - SEE ACCOMPANYING SPEC. SHEET
 7. ALL MATERIAL USED MADE IN THE USA

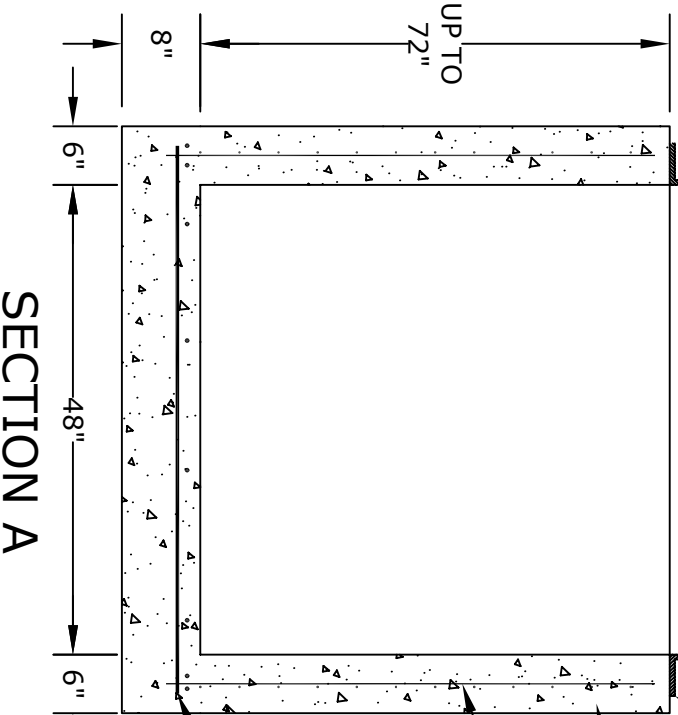

SECTION A

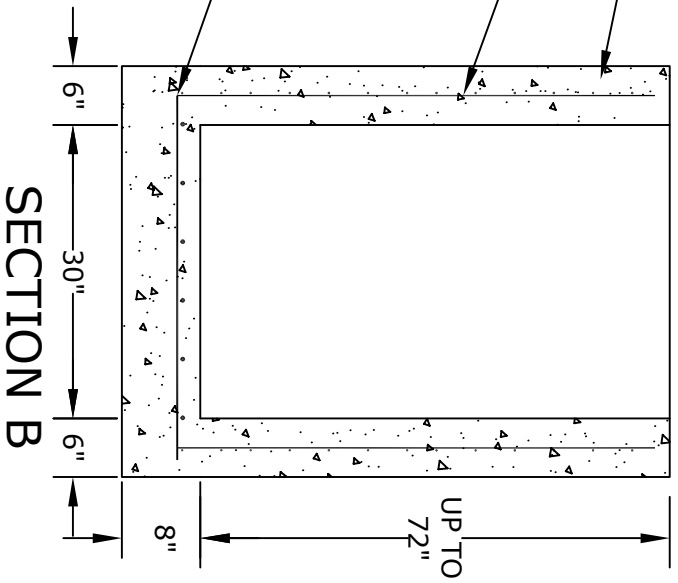

SECTION B

ALTOMARE PRECAST, INC.
4300 Wissahickon Ave.
Philadelphia, PA 19129
Ph: 215-225-8800 Fax: 215-225-8900

TITLE:
**New Jersey
Type D Inlet**

PROJECT:
CONTR:
DATE: