

SECTION A

- NOTES**
1. CONCRETE - 4000 psi, AIR ENTRAINED
 2. REINFORCING STEEL - GRADE 60, ASTM A-615 - REINFORCING BASED ON PENNDOT RC-46M
 3. WELED WIRE FABRIC - ASTM-A185
 4. LADDER RUNGS - COPOLYMER POLYPROPYLENE PLASTIC, w/1/2" REBAR, GRADE 60 WHEN NEEDED
 5. MATERIAL AND CONSTRUCTION SHALL COMPLY WITH PENNDOT PUB. 408, 72, & RC46M
 6. LOCATIONS OF PIPE OPENINGS AS REQUIRED
 7. ALL MATERIAL USED MADE IN THE USA

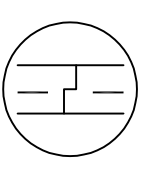

**OPTIONAL JOINT
(WHEN NEEDED)**

REINFORCING PER
RC-46M STANDARDS

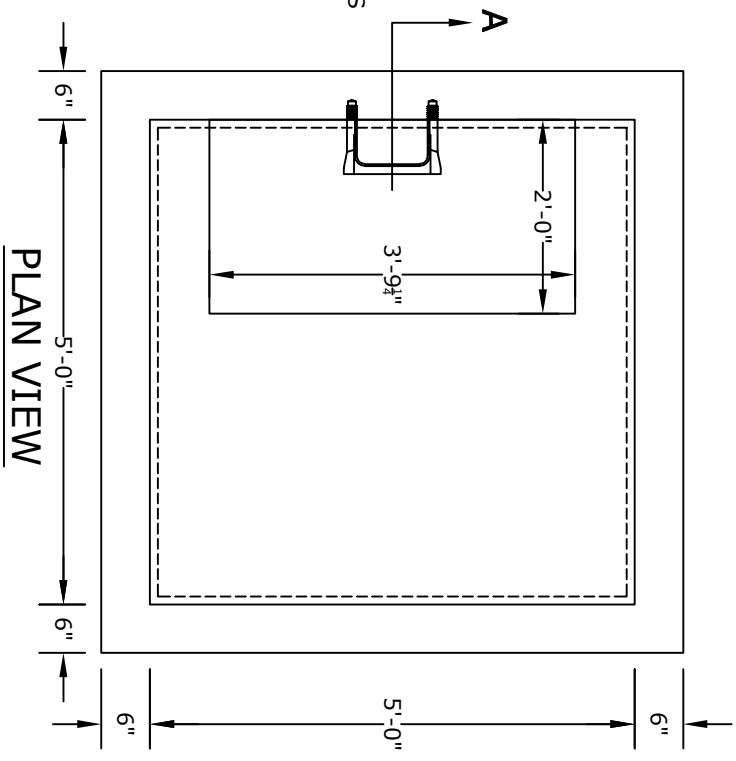

PLAN VIEW

ALTOMARE PRECAST, INC.
 4300 Wissahickon Ave.
 Philadelphia, PA 19129
 Ph: 215-225-8800 Fax: 215-225-8900

TITLE:
**PENNDOT Type 5 Box
 w/ 6" Walls, Deck,
 & 2'x4' Casting**

PROJECT:
CONTR:
DATE: